

# Enrichment

Student Edition  
Pages 346-353

## Scale Drawings

Scale drawings are helpful for planning furniture arrangements. The shapes in the drawing below are similar to the bases of the actual objects, but smaller in size. In the drawing, the scale is  $\frac{1}{4}$  inch = 1 foot, and the side of each small square is  $\frac{1}{4}$  inch.

**Example:** What are the dimensions of the bed in inches?

$$3\frac{1}{2} \times 12 = 42$$

$$6\frac{1}{2} \times 12 = 78$$

The bed is about 42 inches wide and 78 inches long.

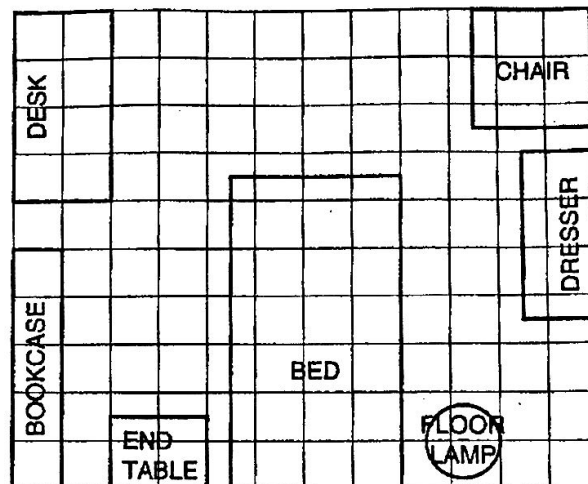

Use the scale drawing above to find the approximate size of each object.

- size of room in feet
- length and width of bookcase in feet
- length and width of dresser in inches
- length and width of end table in inches
- length and width of chair in inches
- diameter of the floor lamp in inches

Show each object on the grid at the right. Use the scale  $\frac{1}{4}$  in. = 1 ft.

- sofa, 72 in. by 36 in.
- coffee table, 24 in. by 48 in.
- chair, 24 in. by 30 in.
- cabinet, 36 in. by 18 in.
- television, 24 in. by 18 in.
- On separate paper, make a scale drawing of a bedroom or living room of your home. Show the furniture.

